

ZRICKS





Zricks.com





ZRICKS

# Office - 1

748 Sq.ft

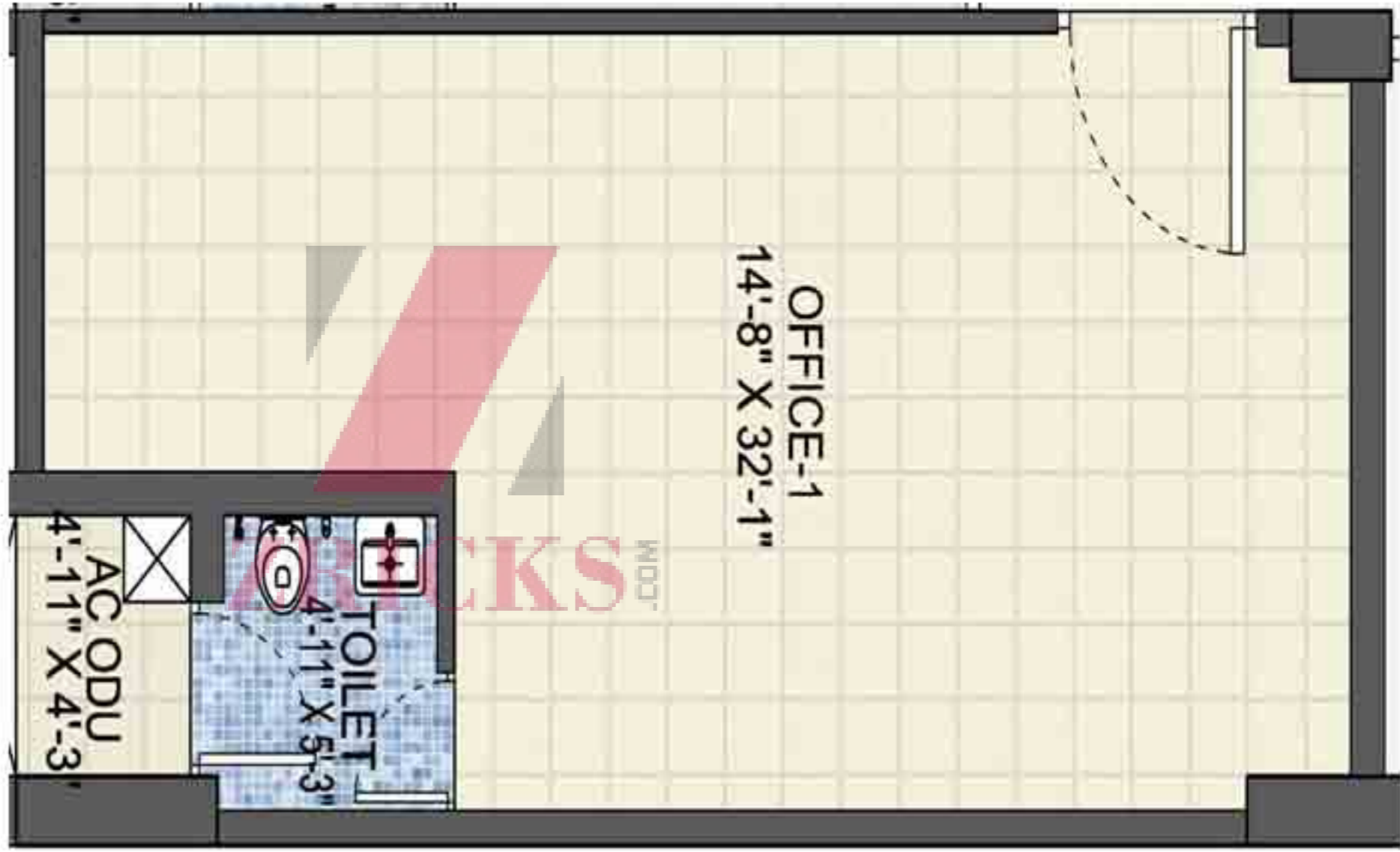



# Office - 7

822 Sq.ft

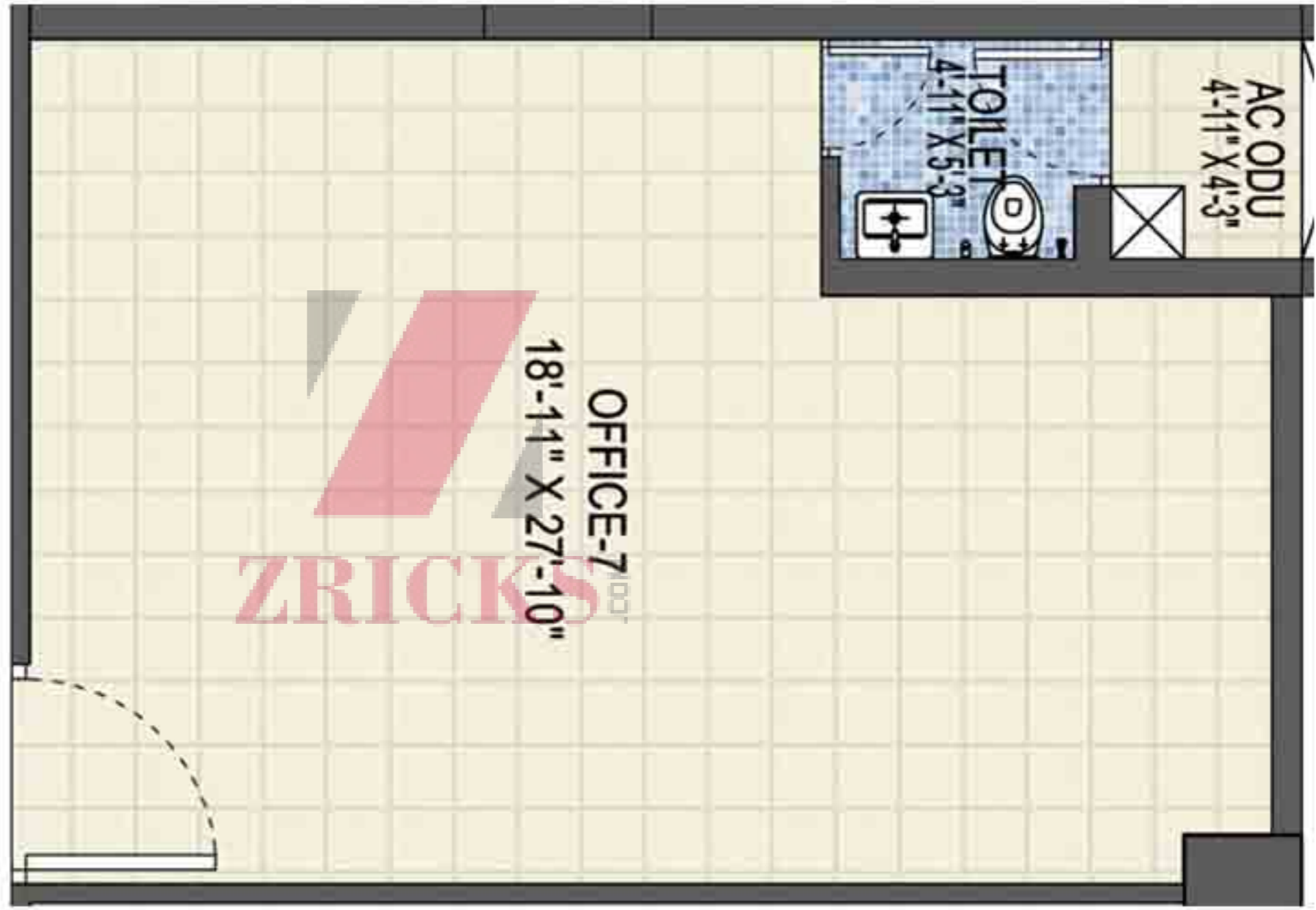

# Office - 3

## 1057 Sq.ft



# Specifications

## **Structure:**

R.C.C. framed structure on pile foundation,  
with brick walls  
P. T flat slab with column capitals

## **Internal Finish:**

Plaster of Paris on all internal cement mortar plastered  
surface

## **Flooring:**

Bare shell office spaces  
Lobby: Italian Marble / Granite  
Stairs: Marble

## **Doors:**

Main entrance lobby: Toughened door  
Main Office: Wooden doors with rolling shutters  
Toilet: Wooden flush doors

## **Electrical:**

Main supply of power will be provided up to the main  
distribution box

## **Sanitary:**

Concealed water supply lines, provision for inlet and  
outlet for customized toilets

## **Railings:**

Stairs will have stainless steel railings

## **Entry & Exit Gate:**

Main steel gates : Security booths alongside  
Basement & Foundations feature with Anti-Termite  
Chemicals  
Roof & Basement protected by water proofing  
treatment

ZRICKS.COM





SL. NO.	BU (SQ.FT)	SBU (SQ.FT)
OFFICE-1	523.45	747.786
OFFICE-2	586.55	837.929
OFFICE-3	740.24	1057.486
OFFICE-4	735.46	1050.657
OFFICE-5	628.22	897.457
OFFICE-6	732.2	1046
OFFICE-7	575.43	822.043
OFFICE-8	415.18	593.114
OFFICE-9	415.18	593.114
OFFICE-10	419.3	599
OFFICE-11	617.14	881.629
TOTAL	6388.35	9126.214

TYPICAL FLOOR PLAN

PROPOSED COMMERCIAL CUM IT BUILDING AT PLOT NO.-X2 BLOCK -EP,  
SEC-V, SALT LAKE CITY, KOLKATA-91

AHESHWARI & ASSOCIATES | 37 BAKER ROAD, ALIPUR,  
KOLKATA-700027 ROYAL PALMS, GOREGAON, MUMBAI-400065







